

CK Direct Ltd are leaders in the Design, Supply, Manufacture and Installation of

## CK Re-Circ™ Units

CK Re-Circ units work as a normal Commercial Kitchen Extract System without the requirement of any external ducting.

With our advanced technology and air purification system CK Re-Circ™ units are suitable for any commercial cooking application.

With standard sized extract systems ranging from 1000 mm wide up to 6000 mm our units will fit anywhere.



Commercial Kitchen Extraction  
ANYWHERE



For use above electrical appliances only CK Re-Circ™ units are suitable for:

- Airports
- Coffee Bars
- Restaurants
- Public Houses
- Shopping Centres
- Football / Sports Stadiums
- Temporary Catering Canteens
- Listed Buildings with planning restrictions

With 4 different stages of Filtration reducing grease, odour and smoke. Giving you total confidence that your new system is

- Clean
- Fire
- Safe
- Cost efficient
- Environmentally Friendly



**Advisory:**

Small extract duct required to remove excess residue.  
Supply air to be fitted to balance system

## Sectors and Clients

CK Direct is an expanding company with a wide range of clients from Blue Chip companies to small independents.

Architects	Specifiers/Consultants	Schools/Colleges	Pub Chains
City Councils	Restaurant Chains	Hotels	Construction Companies



## Accreditations and Skilled People

ISO 9001  
CITY AND GUILDS NVQ LEVEL 3  
DUCT HYGIENE OPERATIVE GRADE 2  
CEDA BOND MEMBERS  
B&ES MEMBERSHIP  
ALL STAFF FULLY TRAINED IN HEALTH AND SAFETY  
ALL OPERATIVES/ DUCT FITTERS TRAINED TO SKILL CARD LEVEL  
SAFE CONTRACTOR & CHAS REGISTERED  
All staff fully trained on extract systems  
Directly employed staff



15 Tresham Road  
Orton Southgate  
Peterborough  
PE2 6SG

T: 01733 230378  
E: info@ckdirect.co.uk  
W: www.ckdirect.co.uk



# CK Recirc™ Units



DESIGN | MANUFACTURE | INSTALL | MAINTAIN

## CK Re-Circ™ ECO Units Specifications

In order to give you a greater choice of electrical cooking equipment, CK ReCirc™ ECO is available in 3 standard sizes. 600 mm Wide 1200 mm wide & 2000 mm wide. All units are fitted with high levels of filtration and single-phase motors. CK Recirc™ ECO units are suitable for Coffee shops, Café's & Bars, Low output Restaurants.

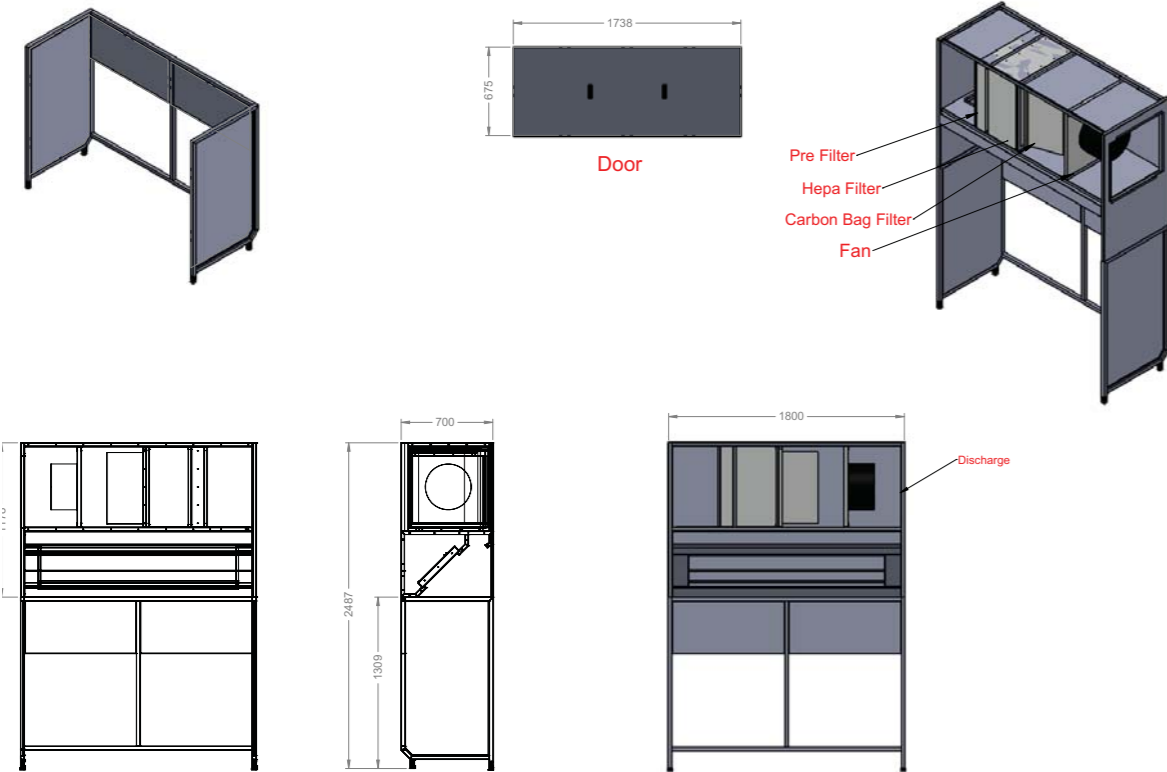

### Filtration Flow

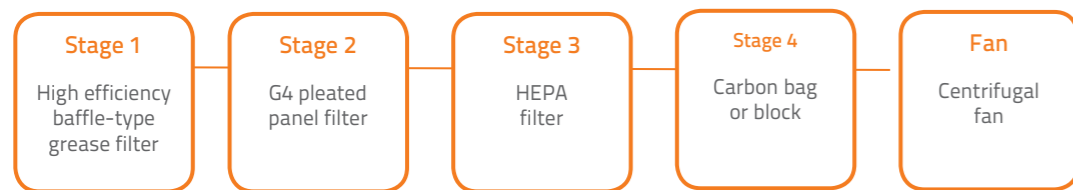

Model Number	Fan Size	Unit Size	Weight	Power	Motor Rating	Air Flow
ECO - 600	CF450	640 x 700 x 2200mm	140kg	1/Phase	0.66KW	0.3m3/sec
ECO - 1200	CF450	1240 x 700 x 2200mm	140kg	1/Phase	0.66KW	0.4m3/sec
ECO - 2000	CF450	2240 x 700 x 2200mm	140kg	1/Phase	0.66KW	0.6m3/sec

## CK Re-Circ™ Units Specifications

The next level of Recirculating System is CK Recirc™. With extract hoods up to 7000 mm long and including island type hoods, the CK Recirc™ will accommodate a far greater cookline than previously achievable. These units are fitted with full size HEPA & Carbons to give you greater cooking scope and highly efficient filtration for a comfortable working environment. The filtration tower can stand in the kitchen next to the canopy or can be fitted remotely. Units are available in 8 standard sizes; bespoke units are also available. These units can accommodate cooking to suit larger outlets. CK Recirc™ Units are suitable for most establishments that carry out light to medium cooking. Such as Hotels, Restaurants, Pubs, Clubs.

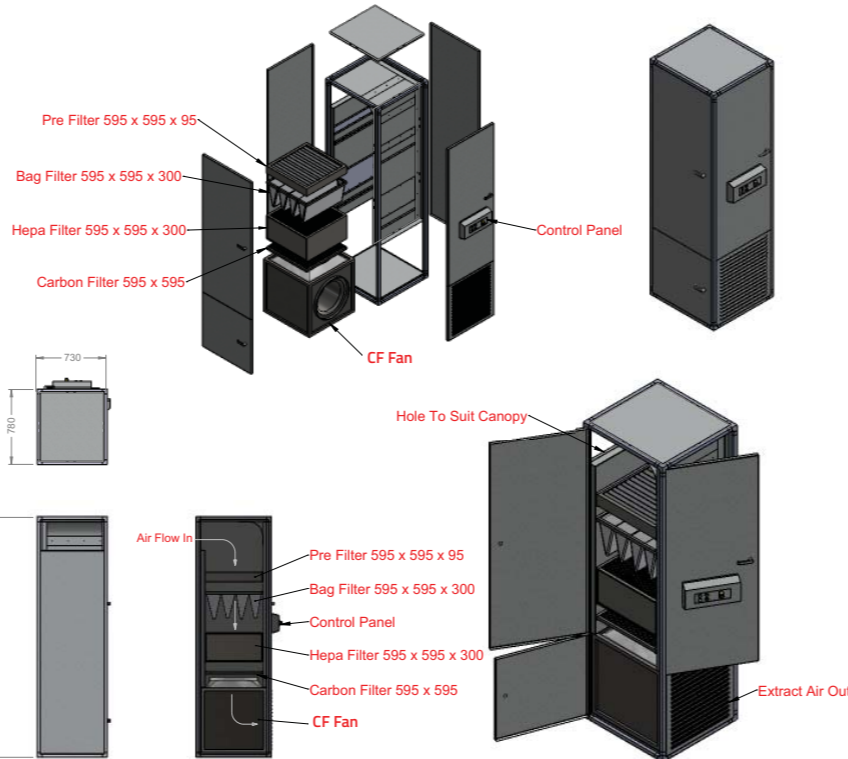

In order to give you a greater choice of electrical cooking equipment, CK ReCirc™ are available in 8 standard sizes but bespoke units are available to whatever size is required, even Island Canopy's.

All units are fitted the same levels of high filtration required. Units are fitted with single phase fan motors for up to 3000 mm canopy system. Over 3000 mm extract fans are fitted with 3 phase fan motors.

Model No.	Canopy size (mm)	Filtration Tower size	Weight (kg)	Fan size	Power	Motor rating	Air Flow
CKRE-100	1000(W) x 1200(D) x 500 (H)	650(W) x 650(D) x 2500(H)	680	CF355	1/phase	0.66KW	0.9m3/sec
CKRE-150	1500(W) x 1200(D) x 500 (H)	650(W) x 650(D) x 2500(H)	710	CF355	1/phase	0.66KW	0.9m3/sec
CKRE-240	2400(W) x 1200(D) x 500 (H)	650(W) x 650(D) x 2500(H)	730	CF355	1/phase	0.66KW	0.9m3/sec
CKRE-300	3000(W) x 1200(D) x 500 (H)	1500(W) x 650(D) x 2500(H)	760	CF400	1/phase	1.50KW	1.2m3/sec
CKRE-350	3500(W) x 1200(D) x 500 (H)	1500(W) x 650(D) x 2500(H)	790	CF400	1/phase	1.50KW	1.2m3/sec
CKRE-400	4000(W) x 1200(D) x 500 (H)	1500(W) x 650(D) x 2500(H)	810	CF450	1/phase	1.50KW	1.6m3/sec
CKRE-500	5000(W) x 1200(D) x 500 (H)	1800(W) x 650(D) x 2500(H)	810	CF450	1/phase	1.50KW	1.6m3/sec
CKRE-600	6000(W) x 1200(D) x 500 (H)	1800(W) x 650(D) x 2500(H)	850	CF355x2	3/phase	1.83KW	2.2m3/sec

## CK Re-Circ™ Recirculation Units

CK ReCirc™ units work as a normal Commercial Kitchen Extract System without the requirement of any external ducting.



Perfect for "Street Food Vendors"

### Accepted

- Westminster City Council Accepted
- Complies to DW172 & BESA
- In line with HSE including HSG173 Monitoring strategies for toxic substances
- Environmental & Occupational Hygiene Tested
- Certified by Independent ISO 17025 UKAS accredited testing laboratory.



### Suitable Locations

- Airports
- Coffee Bars
- Restaurants
- Pubs / Bars
- Cafés
- Shopping Centres
- Temporary Catering Canteens
- Listed buildings with Planning Restrictions
- Can be easily dismantled and re-located.

### Approved alternative to high level kitchen extract, Reduce fire risk, Flexible locations, Emissions control

- Designed to accommodate multiple pieces of electrical equipment.
- For use with electrical appliances only.
- Free-standing self-contained recirculation unit to increase capacity.
- Four stage filtration process to reduce grease, fine particulate, smoke and odours.
- No ducting to atmosphere is required.
- Quick and simple to install.
- Variable fan speed.
- Air movement up to 2.5m<sup>3</sup> per second